

Instructions: How To Log Into Google Classroom From Home

1. Open your computer/tablets browser e.g. Google. Internet Explorer etc.
2. In the search bar type in: [google.com/drive](https://drive.google.com/)

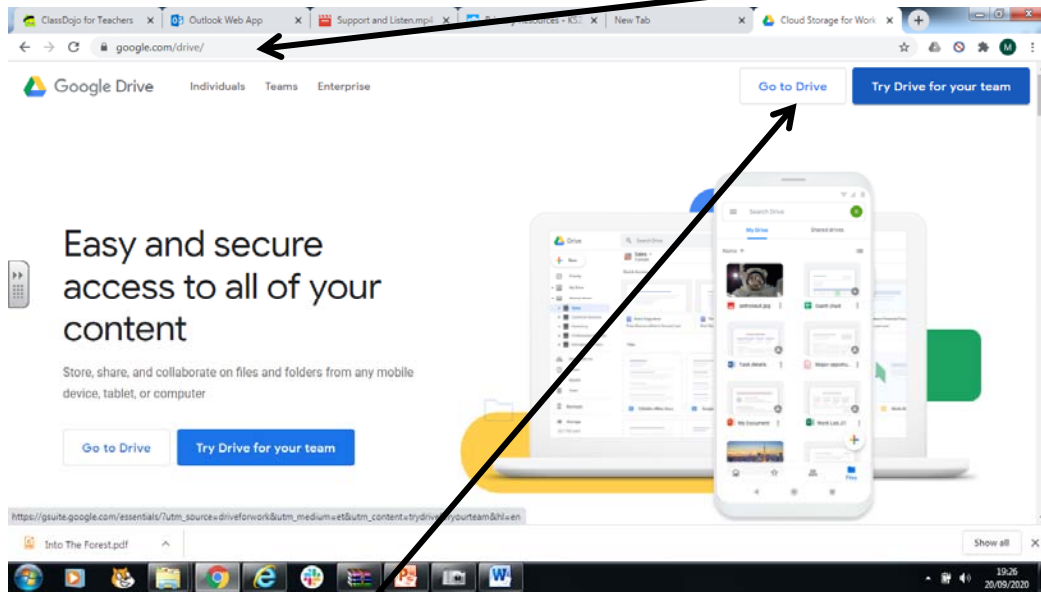

3. Click on Go to Drive
4. Sign in using complete username e.g. smithJ001.309@risleyavenue-pri.haringey.sch.uk

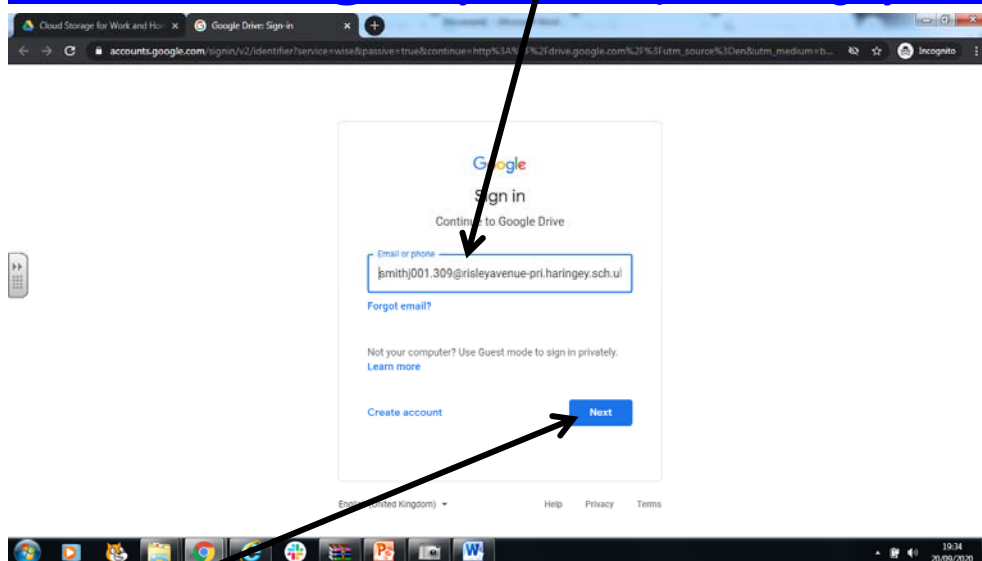

5. Click Next

6. Type short username and password
e.g.smithj001.309

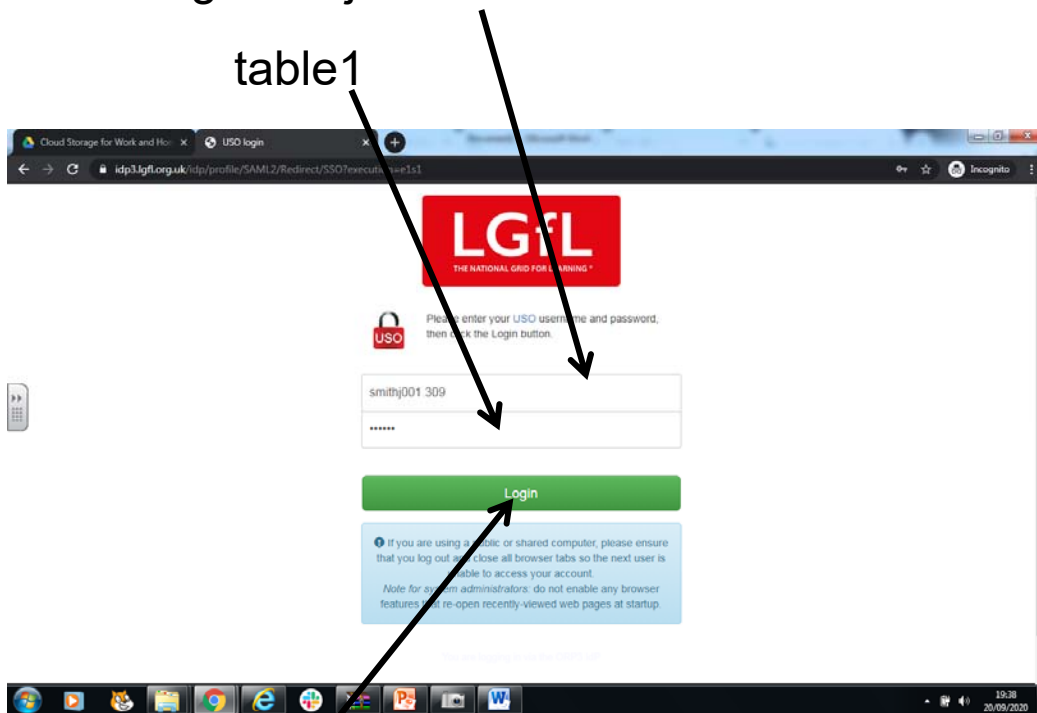

7. Click Login

8. Click Accept

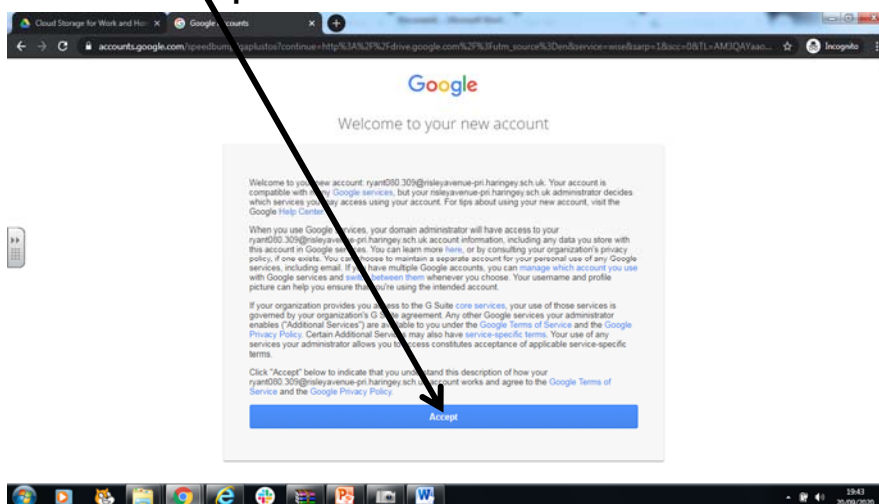

9. Click on the 9 little squares in the top right hand corner of the screen

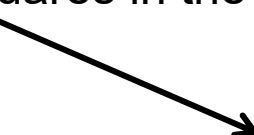

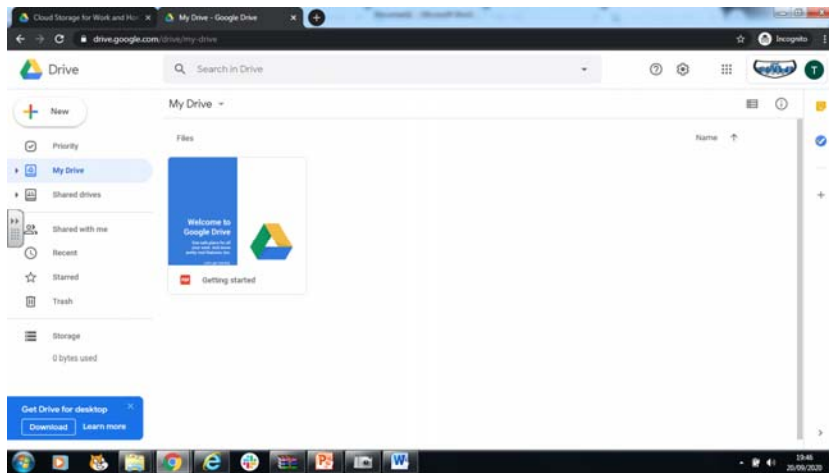

10. Click on Classroom

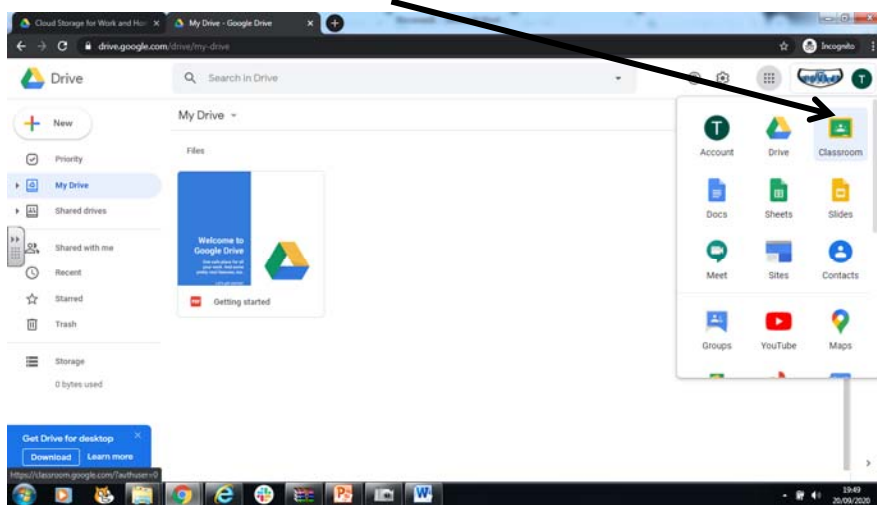

11. Click Continue

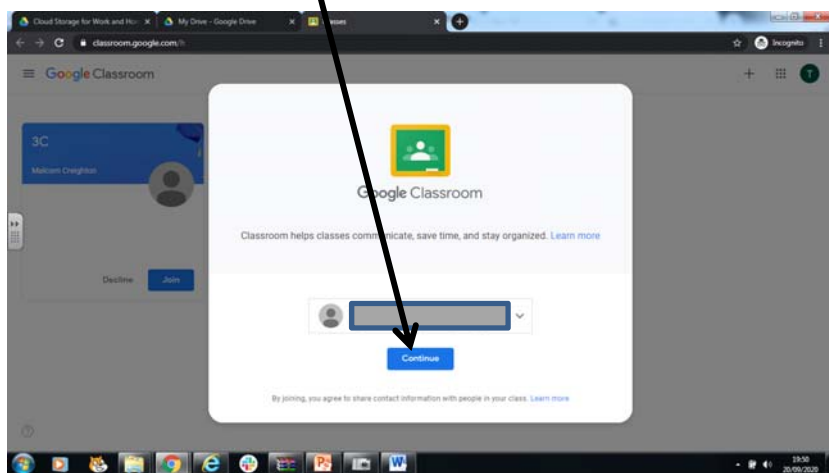

12. Click I'm a student

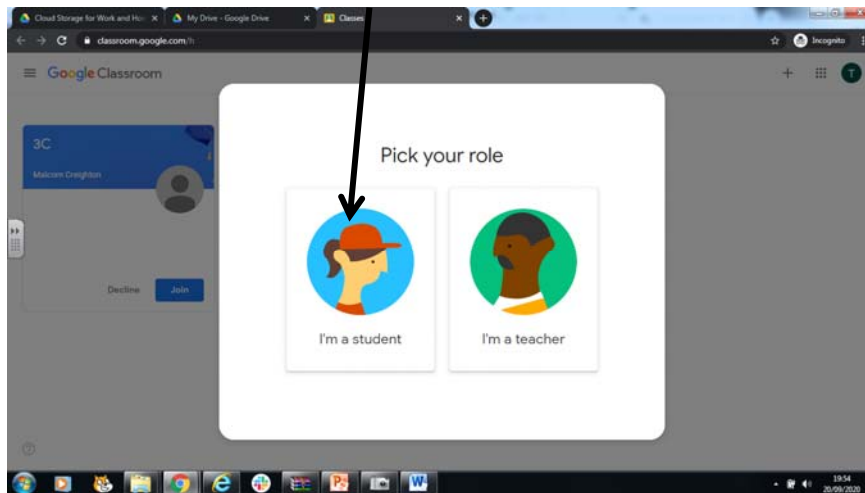

13. Click Join on 3C Malcolm Creighton Classroom

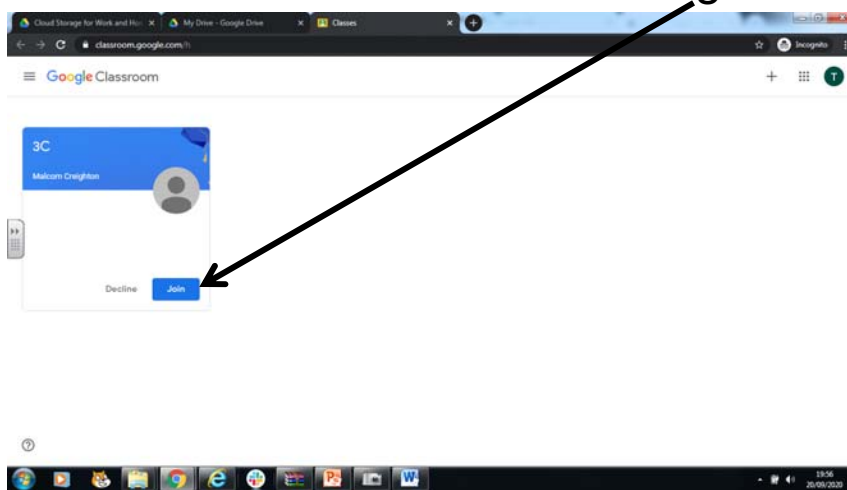

Welcome to 3C's Classroom!

The next time you log in repeat steps 1-7.